

5 Rainbow Close, Chorlton, Manchester, M21 8RY



JP&Brimelow
ESTATE AGENTS

Offers In The Region Of £320,000

****VIDEO TOUR AVAILABLE**** An attractive TWO DOUBLE BEDROOMED, garden fronted, mid-terrace property, situated on a quiet residential cul-de-sac location off Claude Road. Within easy walking distance to all the independent shops, bars and restaurants on Beech Road, Beech Road Park, Chorlton Nature Reserve. Brookburn School and Chorlton Park are both fantastic primary schools nearby. In brief the accommodation comprises; a lounge to the front aspect and a fitted kitchen/dining room to the ground floor, providing access into the rear enclosed South facing garden. To the first floor there is a landing leading to two double bedrooms and a three-piece family bathroom. The property benefits from gas central heating warmed by a Worcester Boiler, double glazing throughout, a fully boarded loft with a built in ladder and a driveway providing off-road parking. This property would suit a professional, a couple or a small family. Early internal inspection is highly recommended.





EPC Chart

Energy Efficiency Rating

	Current	Potential
Very energy efficient - lower running costs		
(92 plus) A		91
(81-91) B	74	
(69-80) C		
(55-68) D		
(39-54) E		
(21-38) F		
(1-20) G		
Not energy efficient - higher running costs		
England & Wales	EU Directive 2002/91/EC 	



Tenure: **Freehold** Council Tax Band: **B**

Ground Floor

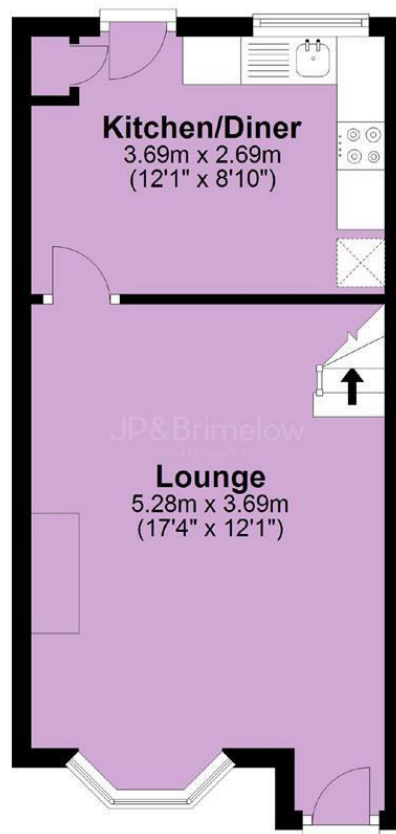

First Floor

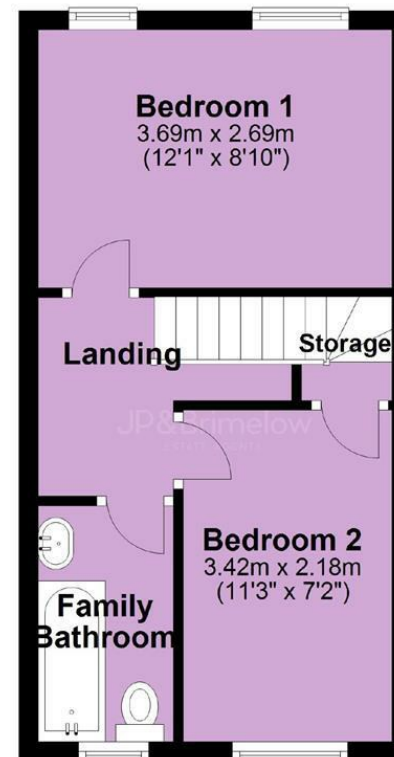

Chorlton & Didsbury Ltd
 430 Barlow Moor Road, Chorlton, Manchester, M21 8AD
 Chorlton: 0161 882 2233 Didsbury: 0161 448 0622
 E: chorlton@jpbrimelow.co.uk www.jpbrimelow.co.uk



JP&Brimelow
 ESTATE AGENTS

NOTICE: J P & Brimelow Chorlton & Didsbury Ltd for themselves and for the vendors or lessors of this property whose agents they are give notice that:

- (i) the particulars are set out as a general outline only for the guidance of intending purchasers or lessees, and do not constitute, nor constitute part of, an offer or contract;
- (ii) all descriptions, dimensions, references to the condition and necessary permissions for use and occupation, and other details are given in good faith and are believed to be correct but any intending purchasers or tenants should not rely on them as statements or representations of fact but must satisfy themselves by inspection or otherwise as to the correctness of each of them;
- (iii) no person in the employment of JP & Brimelow Ltd has any authority to make or give any representation or warranty whatever in relation to this property.



Follow us on Twitter @jpandbrimelows